

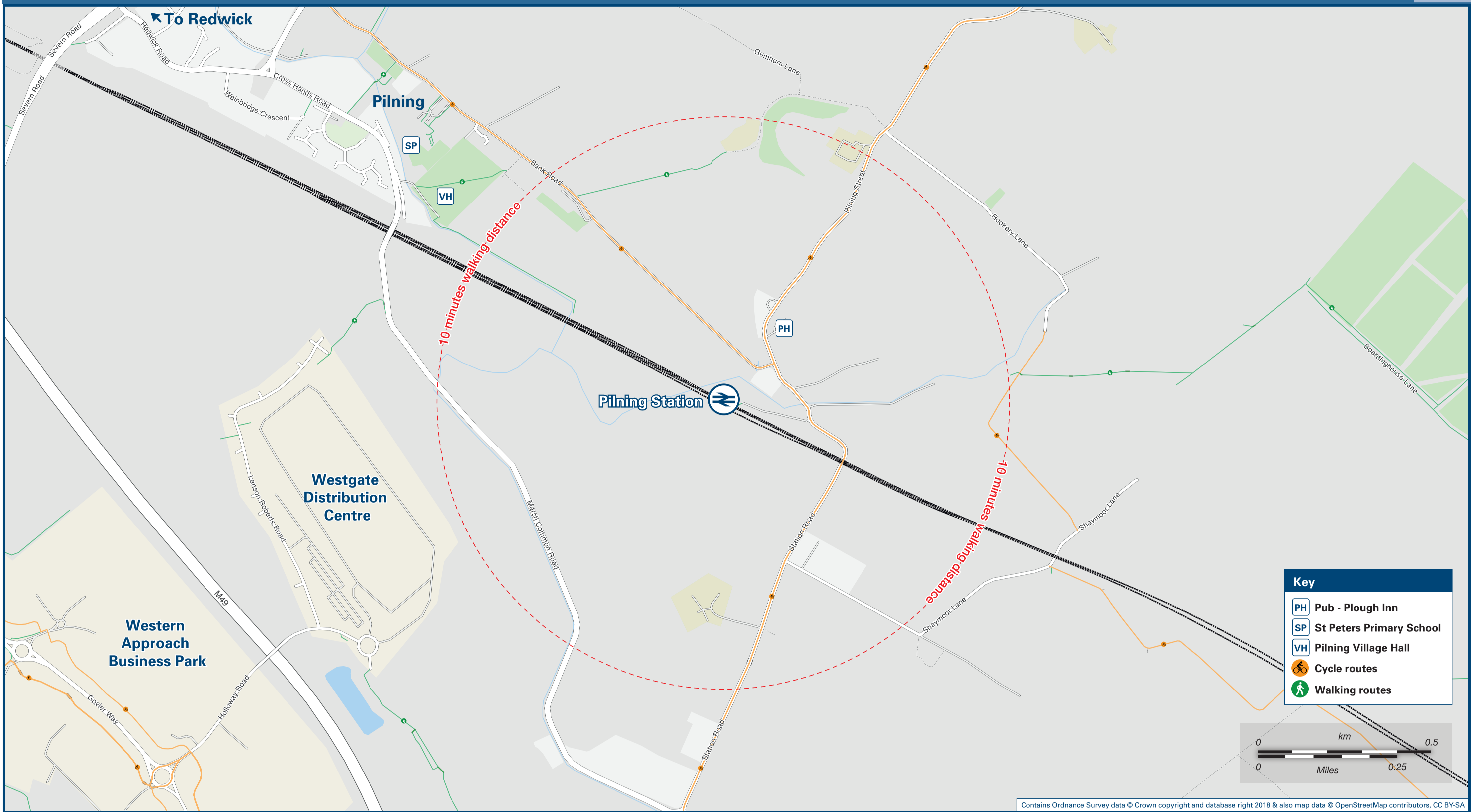

Pilning Station

Onward Travel Information

Local area map



Station Map

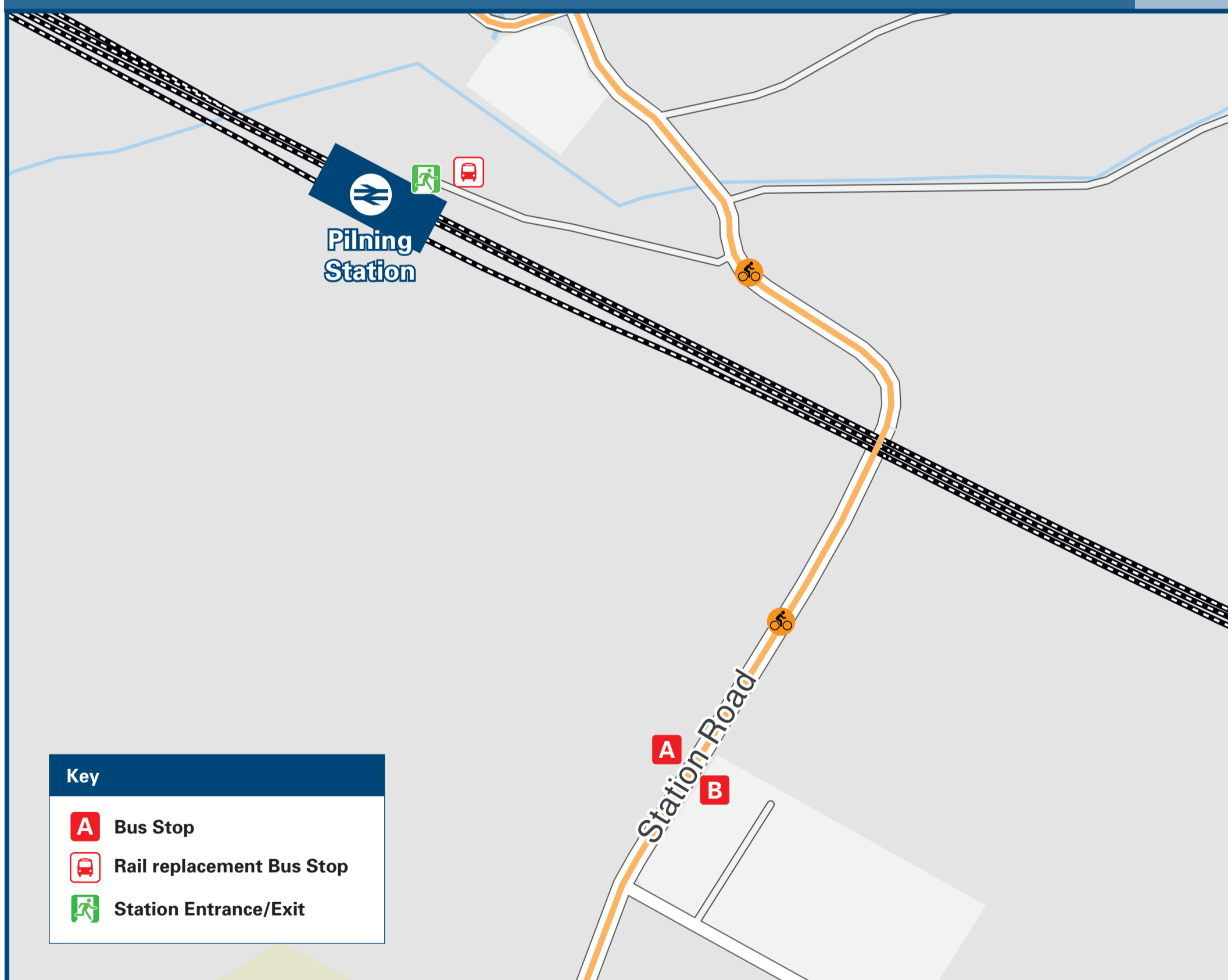

In the event of engineering work, taxis will collect from the front of the station

Information

(Data correct at September 2019)

Bus interchange points at Cribbs Causeway, Frenchay UWE Campus, Kingswood and Yate Town can be used to access services across a wider area

No regular bus service calls at this Station (Stops A & B) on the Buses map

Bus route 625 to Frenchay UWE Campus calls at Stop {B} at 0809 on Mondays to Fridays only and operates via Cribbs Causeway, Patchway and Bristol Parkway station.

Bus route 625 to Severn Beach calls at Stop {A} at 1547 on Mondays to Fridays only and operates via Pilning Village

There are hourly buses from Pilning Village (service 625 on Mondays to Saturdays) to Severn Beach, Cribbs Causeway, Patchway, Bristol Parkway station and Frenchay UWE Campus, and 4 journeys from Pilning Village (also service 625 on Sundays) to Severn Beach and Cribbs Causeway only

Pilning station has no taxi rank or cab office. Advance booking is essential, please consider using the following local operators: (Inclusion of this number doesn't represent any endorsement of the taxi firm)

South Glous Taxi
0117 977 7777

Prestige Cars
0117 950 9999

Trymside Taxis
0117 968 5206

Further information about all onward travel

| | | | | |
|--|--|--|---|---|
| Local Cycle Info Travelwest.info <small>For more information about cycle routes.</small> | National Cycle Info sustrans.org.uk <small>Sustrans is the UK's leading sustainable transport charity.</small> | Bus Times <small>See timetable displays at bus stops.</small> www.traveline.info <small>0871 200 22 33</small> <small>calls cost 13p per minute plus your phone company's access charge</small> | NextBuses Find the bus times for your stop. <small>Search for a bus stop by entering a postcode, street & town or a stop name & town.</small> | PlusBus plusbus.info <small>A discount price 'bus pass' that you buy with your train ticket. It gives you unlimited bus travel around your chosen town, on participating buses.</small> |
|--|--|--|---|---|

National Rail Enquiries

| | | | | | |
|---|---|--|--|--|---|
| Online nationalrail.co.uk | NRE App Free National Rail Enquiries app for iOS and Android | Social Media facebook.com/nationalrailenq @nationalrailenq | Alert Me <small>You can sign up to Alert Me messages on the National Rail Enquiries website where you can receive train and platform notifications directly to your smart phone.</small> nationalrail.co.uk/alertme | Contact Centre 03457 48 49 50 <small>Calls cost no more than calls to geographic numbers (01 or 02) and may be recorded.</small> | PlusBike nationalrail.co.uk/plusbike <small>For more information.</small> |
|---|---|--|--|--|---|



Whilst considerable care has been taken to ensure the information contained on this poster is correct and accurate, National Rail cannot accept responsibility for any loss or inconvenience caused by any errors or omissions, or for loss, damage, injury or inconvenience caused. For any feedback, please e-mail comments@onwardtravelposters.com

Scan this code with your mobile to take this poster with you.